

AUGUST 6-11
2022
JSM
WASHINGTON, DC

QUICK GUIDE

*American Statistical Association

Casualty Actuarial Society

The Caucus for Women in Statistics

*International Biometric Society (ENAR and WNAR)

International Chinese Statistical Association

International Indian Statistical Association

*Institute of Mathematical Statistics

International Society for Bayesian Analysis

International Statistical Institute

Korean International Statistical Society

Royal Statistical Society

*Statistical Society of Canada

**Indicates the founding societies of JSM*

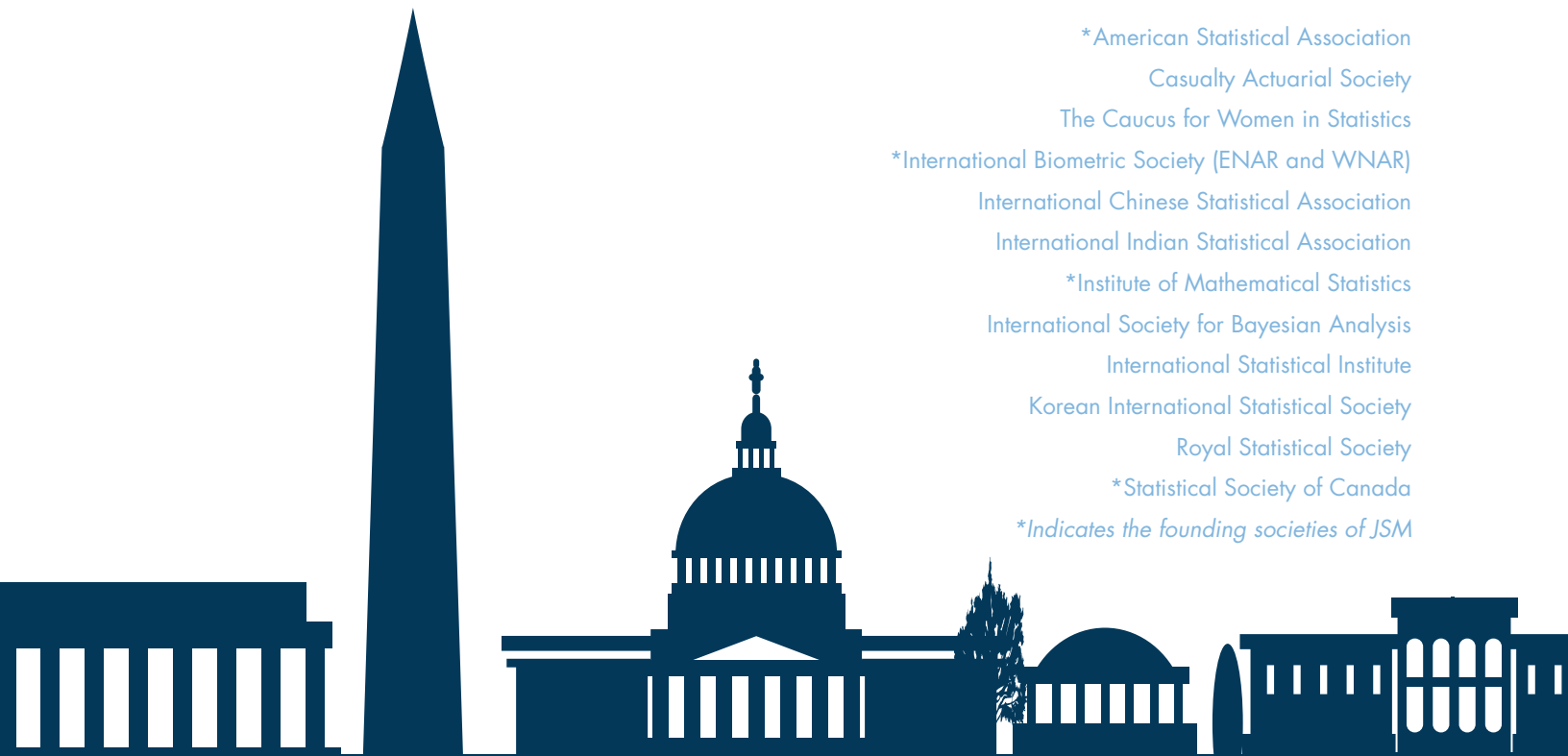

STATISTICS: A FOUNDATION FOR INNOVATION

JSM 2022

WASHINGTON, DC

Thank you to our JSM 2022 sponsors

PLATINUM

abbvie

sas

Takeda

GOLD

AstraZeneca

BeiGene

Berry Consultants
Statistical Innovation

Lilly

jmp
STATISTICAL
DISCOVERY

MERCK
INVENTING FOR LIFE

Meta

NSA
WHERE INTELLIGENCE GOES TO WORK®

STATA®

www.IntelligenceCareers.gov/NSA

2σ TWO SIGMA

UNLEARN

Westat®

SILVER

ADDINSOFT
DATA SCIENCE
MADE SIMPLE

Biogen

Bristol Myers Squibb™

Carnegie Mellon University
Software Engineering Institute

Daiichi-Sankyo

MIT
MIT
MANAGEMENT
BUSINESS ANALYTICS

NSF

NOVARTIS

Otsuka

Pacific Northwest
National Laboratory

P&G

RTI
INTERNATIONAL

United States™
Census
Bureau

VERTEX

WILEY

Find out more at www.amstat.org/jsmsponsors

EXPLORE THE PROGRAM VIA THE JSM 2022 APP!



Sponsored by Takeda

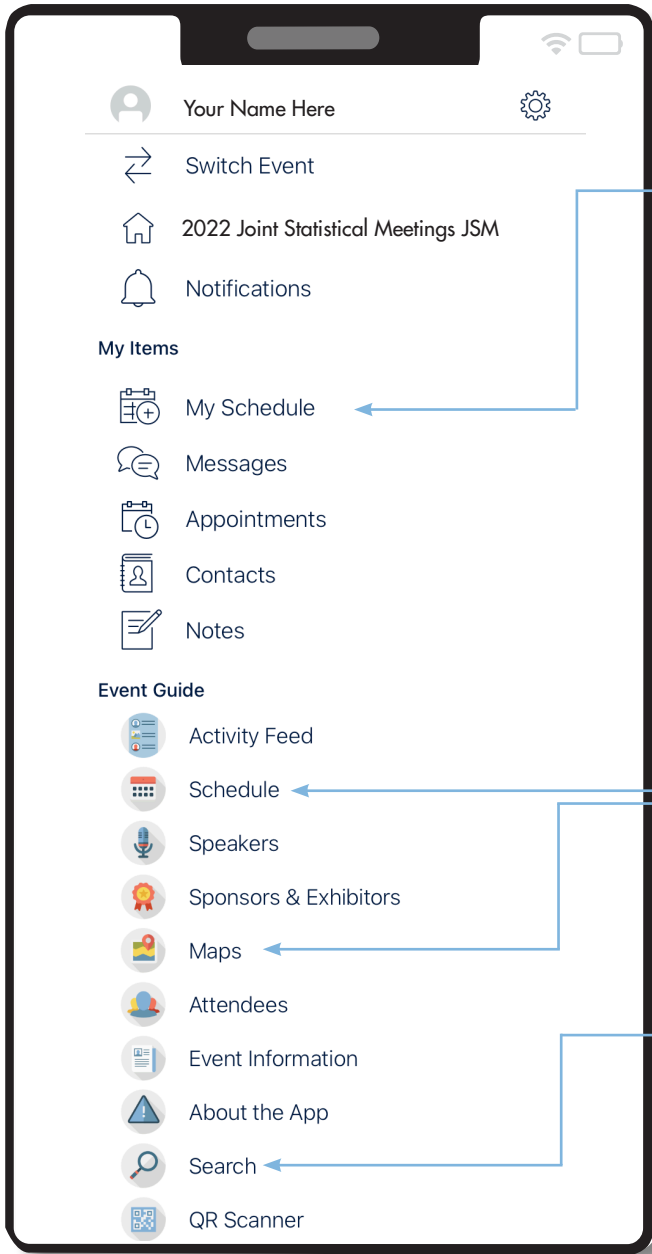

Looking for the complete JSM program schedule? Just click the schedule icon!

Scroll through all JSM sessions, the professional development program, business and committee meetings, and JSM hours and events by day. And don't forget to add these to your personal schedule by clicking the "+" icon.

Need to know when speed sessions are taking place? Simply select the "Contributed Speed" tag from the filter options—and *voila!* Looking for all sessions sponsored by the Section on Statistics in Sports? Filter by track instead.

Not sure where a room is located? Just hit the maps icon and the app will show you.

Trying to find something specific? Search for a speaker or find an abstract via keyword or session title.



GET THE JSM APP!

Scan the QR code to download the app.

Or download the **CrowdCompass Events app** in **Google Play** or **Apple's App Store**, and then search for JSM.



And don't forget to leave feedback on the presentations you see. Just click the link provided in the session details.

GOOD TO KNOW



JSM CHALLENGE

Take the **JSM CHALLENGE** via the JSM 2022 app! Earn points for each task you complete to win prizes at the end of the week. The JSM Challenge runs Saturday through Thursday, with new tasks each day. Prizes will be awarded to the top four participants on the leaderboard within the JSM app as of noon on Thursday.

Don't miss out on the opportunity to have fun and win great prizes! Download the CrowdCompass Events app and search for Joint Statistical Meetings. Available from Google Play and the App Store.

DOCENT PROGRAM

QUESTIONS? NEW TO JSM? Find a JSM docent to help you learn the ropes. JSM docents are experienced JSM attendees wearing an orange button who can help you make the most of your experience.



WI-FI *Sponsored by AbbVie*

WALTER E. WASHINGTON CONVENTION CENTER

Network: JSM2022
Password: abbvie22

MARRIOTT MARQUIS

Network: JSM2022
Password: abbvie22

JSM PROCEEDINGS

Eligibility guidelines and author instructions for **JSM 2022 PRESENTERS** are available at ww2.amstat.org/meetings/jsm/2022/submissions.cfm. The submission site will be open September 1 – October 7, 2022 (11:59 p.m. EDT).





EMERGENCY TELEPHONE MESSAGES

In case of emergency, messages may be left during registration hours by calling (202) 249-4005. We will attempt to contact the registrant using the contact information provided in their registration.



ASSISTANCE FOR THOSE WITH DISABILITIES

Please contact a staff member at the Help Desk in the registration area if you have a disability that may impede your participation.



CHILD CARE

Kiddie Corp is the official child care provider for JSM 2022. Arrangements should have been made in advance. Please contact Kiddie Corp at (858) 455-1718 or info@kiddiecorp.com for any questions or possible availability.

POLICIES

Electronic Devices

All cell phones, pagers, and other electronic devices should be silenced before attending any session or meeting.

Smoking/Vaping

Smoking is not permitted at any JSM function, unless the event is held outside.

Sustainability/Recycling

The “Know the Code” color-coded recycling and waste minimization program has helped the convention center take the lead on extensive recycling initiatives and effectively employing environmentally responsible products. Through a PepsiCo partnership, PepsiCo’s recycling “dream machines” were installed surrounding the center to encourage beverage container recycling rates.

The convention center partners with many local sustainable businesses—including DC Central Kitchen, Capital Area Food Bank, and the District of Columbia Department of Public Works—to recycle pallets left by decorators.

Activities Conduct Policy

As a professional society, the American Statistical Association is committed to providing an atmosphere that encourages the free expression and exchange of ideas. Consistent with this commitment, it is the policy of the ASA that all participants in ASA activities will enjoy a welcoming environment free from unlawful discrimination, harassment, and retaliation. All participants in ASA activities also agree to comply with all rules and conditions of the activities, which are subject to change without notice.

Please read the complete code of conduct at www.amstat.org/meetings/code-of-conduct.



GOOD TO KNOW

CC = Walter E. Washington Convention Center
M = Marriott Marquis Washington DC

REGISTRATION AND ASA MEMBERSHIP/ HELP DESK/ PRESS DESK

CC-East Salon

Saturday
7:30 a.m. – 6:00 p.m.

Sunday
7:30 a.m. – 8:30 p.m.

Monday – Tuesday
7:30 a.m. – 6:00 p.m.

Wednesday
7:30 a.m. – 4:30 p.m.

Thursday
7:30 a.m. – 10:30 a.m.

SPEAKER READY ROOM

Sponsored by AbbVie

CC-209



Sunday
9:00 a.m. – 7:00 p.m.

Monday – Wednesday
7:00 a.m. – 6:00 p.m.

Thursday
7:00 a.m. – 10:30 a.m.

CAREER SERVICE

CC-Hall E

Saturday
9:00 a.m. – 5:00 p.m.
(pre-registered attendee badge pick-up and onsite registration only)

Sunday
1:00 p.m. – 6:00 p.m.

Monday – Tuesday
8:00 a.m. – 5:30 p.m.

Wednesday
8:00 a.m. – 2:30 p.m.
(onsite registration closes at noon)

EXPO 2022 AND ASA STORE

CC-Hall D

Sunday
1:00 p.m. – 6:00 p.m.
8:30 p.m. – 10:30 p.m.

Monday – Tuesday
9:00 a.m. – 5:30 p.m.

Wednesday
9:00 a.m. – 2:30 p.m.

DESTINATION DC RESTAURANT & TOURISM INFORMATION CENTER

CC-Grand Lobby

Saturday – Wednesday
10:00 a.m. – 6:00 p.m.



SHARE JSM
Tag #JSM2022 and
@AmstatNews



NEW PRODUCTS AVAILABLE FOR JSM

Visit the ASA Store in the EXPO!

GOOD TO KNOW

JSM LUGGAGE STORAGE

CC-East Salon

Wednesday
8:00 a.m. – 6:30 p.m.

Thursday
8:00 a.m. – 1:00 p.m.



NEW MOTHERS

Lactation pods are available.

Go to the Help Desk in the registration area for the locations and entry code.



FOOD CONCESSIONS

Looking for coffee, lunch, a snack? Why not head to **Uptown Dining District** (right outside Hall D) and grab something to eat before heading into the EXPO to check out the cutting-edge companies showcased on the exhibit floor.

MIT
MANAGEMENT
BUSINESS ANALYTICS

#MITANALYTICS
#ANALYTICSCAPSTONE

**Solving Data Science
Challenges to Optimize
your Business**

Find Out More: analyticscapstone.mit.edu

FEATURED SPEAKERS

CC = Walter E. Washington Convention Center
M = Marriott Marquis Washington DC

MONDAY



ASA PRESIDENT'S INVITED ADDRESS

Reginald DesRoches, Rice University

*The Importance of Statistics in a
Liberal Arts Education*

4:00 p.m. • CC-Ballroom BC

TUESDAY



IMS MEDALLION LECTURE I

Dylan Small, University of Pennsylvania

*Protocols for Observational Studies:
Methods and Open Problems*

8:30 a.m. • CC-202A



COPSS ELIZABETH L. SCOTT LECTURE

Madhu Mazumdar, Icahn School of
Medicine at Mount Sinai

*Biostatistical Methods and Team Science:
Generating Evidence for Optimization of
Clinical Practice*

2:00 p.m. • CC-207A

WI-FI

Sponsored by AbbVie

WALTER E. WASHINGTON CONVENTION CENTER

Network: JSM2022

Password: abbvie22

MARRIOTT MARQUIS

Network: JSM2022

Password: abbvie22

FEATURED SPEAKERS

TUESDAY



ASA DEMING LECTURE

David L. Banks, Duke University

Deming and the Industries of Today

4:00 p.m. • CC-Ballroom BC



ASA PRESIDENT'S ADDRESS AND AWARDS

Katherine Ensor, Rice University

*Celebrating Statistical Foundations Driving
21st-Century Innovation*

8:00 p.m. • CC-Ballroom BC

WEDNESDAY



IMS MEDALLION LECTURE II

Huixia Judy Wang,
The George Washington University

Extreme Conditional Quantiles

10:30 a.m. • CC-207A



COPSS DISTINGUISHED ACHIEVEMENT AWARD AND LECTURESHIP

Nancy Reid, University of Toronto

Likelihood and Its Discontents

4:00 p.m. • CC-Ballroom BC

Passion for Innovation.
Compassion for Patients.™

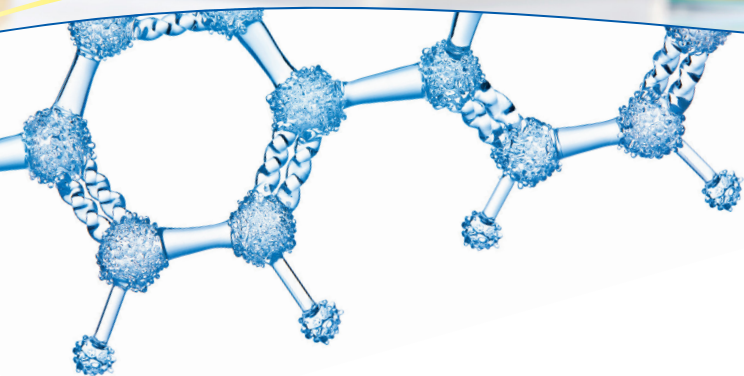

**VISIT BOOTH #212
TO LEARN MORE**



Daiichi Sankyo is dedicated to creating new modalities and innovative medicines by leveraging our world-class science and technology to contribute to the enrichment of quality of life around the world.

With more than 100 years of scientific expertise, our 16,000 employees across 20 countries build on our legacy through ongoing research to create world-class medicines, pairing existing and new ideas to realize our 2030 Vision to become an *Innovative Global Healthcare Company Contributing to the Sustainable Development of Society*.

Daiichi Sankyo is primarily focused on developing novel therapies for people with cancer as well as other diseases with high unmet medical needs. Learn more at [DaiichiSankyo.us](https://www.DaiichiSankyo.us).

INTRODUCTORY OVERVIEW LECTURES

Sunday, August 7, 4:00 p.m. • CC-207A

Session 36 - Computational Advertising

Monday, August 8, 8:30 a.m. • CC-207A

Session 81 - Sports Analytics: Step Up to the Plate

Tuesday, August 9, 8:30 a.m. • CC-207A

Session 215 - Interface Between Randomized Controlled Trials and Real-World Studies: Principle, Practice, and Perspective for Precision Medicine Development

Wednesday, August 10, 8:30 a.m. • CC-207A

Session 359 - Statistics and Networks: Looking Back and Looking Forward

LATE-BREAKING SESSIONS

Monday, August 8, 2:00 p.m.

CC-207A

Session 171 - Accelerating Transparency in National Statistics

Tuesday, August 9, 10:30 a.m.

CC-207A

Session 251 - Algorithmic Bias and Public Policy

CC = Walter E. Washington Convention Center

M = Marriott Marquis Washington DC

It's not only
what you do,
it's **why** you do it.

Whatever your field, NSA has a position that combines your expertise with our mission: the safety and security of our families, our community and our country.

Ask us about our Math Careers
IntelligenceCareers.gov/NSA



NATIONAL
SECURITY
AGENCY

U.S. citizenship is required.
NSA is an Equal Opportunity Employer.

FEATURED EVENTS

CC = Walter E. Washington Convention Center

M = Marriott Marquis Washington DC



FIRST-TIME ATTENDEE ORIENTATION AND RECEPTION

Sponsored by Novartis

Sunday, August 7
12:30 p.m. – 2:00 p.m.

CC-Ballroom Level
South Prefunction

Join fellow first-timers at this orientation and reception to learn how to get involved in JSM.

JSM OPENING MIXER & INVITED POSTER SESSIONS

Sponsored by Eli Lilly & Company and Westat

Sunday, August 7
8:30 p.m. – 10:30 p.m.

CC-Hall D

All conference attendees are encouraged to come together for the kick-off social event of JSM.



JSM STUDENT MIXER

Sponsored by Two Sigma

Monday, August 8
6:00 p.m. – 8:00 p.m.

M-Independence Ballroom

The Student Mixer provides an opportunity for students to join their contemporaries for a fun-filled time.

FEATURED EVENTS

JSM DANCE PARTY

Tuesday, August 9

9:30 p.m. – 12:00 a.m.

CC-Ballroom A

A fun highlight of JSM, the dance party is held right after the ASA President's Address and Awards. There are snacks, a cash bar, and music!

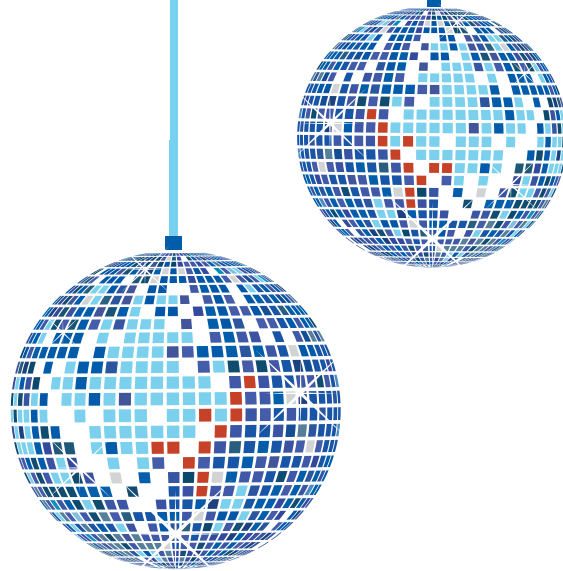

Enhance Your Career With an Online Master of Science in Biostatistics

- Same curriculum and faculty as our renowned on-campus program
- Study under faculty leaders in health-related scientific research including big data, clinical trials, study design, metabolomics, genomics and survival analysis
- Offers flexibility to study at times and locations convenient to student
- Two degree concentrations available: Biostat. Methods and Practice & Health Data Science

Apply Now for Fall 2023!

biostat.ufl.edu/MSONline

UF UNIVERSITY of
FLORIDA



Where is the best place to grab a treat and network with other attendees? Inside the JSM EXPO, of course! Join us for featured events throughout the week in the Spotlight area.



Sunday, August 7

1:00 P.M.

SPOTLIGHT DC KICK-OFF

Swing by and kick off JSM with tasty gelato. Sample three flavors—vanilla bean, strawberry, and Stracciatella—while getting your first look at the JSM EXPO.

3:30 P.M.

FRESH DONUTS

Sweet tooth? Sample fresh, warm donuts in flavors such as strawberry glazed, Funfetti, milk chocolate, peanut, brown butter, vanilla bean glazed, and crème brûlée. Grab one or two (while supplies last) and mingle with other attendees.

SPOTLIGHT EVENTS

Monday, August 8

10:00 A.M. JSM COFFEE HOUSE

Refresh with a cup of freshly brewed coffee or a selection of teas.

11:00 A.M. JSM PHOTO BOOTH

Sponsored by Unlearn.AI

Swing by for snapshots with your friends using fun props.

1:30 P.M. POPCORN BREAK

Enjoy an afternoon pick-me-up with a warm bag of popcorn.

3:30 P.M. DC MICROBREW TASTING

Stop by to taste a variety of local area microbrews and cider (while supplies last).

Tuesday, August 9

10:00 A.M. JSM COFFEE HOUSE

Refresh with a cup of freshly brewed coffee or a selection of teas.

1:30 P.M. POPCORN BREAK

Enjoy an afternoon pick-me-up with a warm bag of popcorn.

3:30 P.M. SAMPLE NORTHERN VIRGINIA WINES

Virginia has wine? Who knew? Don't miss this chance to taste them (while supplies last).

Wednesday, July 10

10:00 A.M. JSM COFFEE HOUSE

Refresh with a cup of freshly brewed coffee or a selection of teas.



Need a breather?

Head over to **CC-301** for quiet reflection time.

Sunday, August 7 7:30 a.m.–10:30 p.m.

Monday, August 8 7:00 a.m.–6:30 p.m.

Tuesday, August 9 7:00 a.m.–9:30 p.m.

Wednesday, August 10 7:00 a.m.–6:30 p.m.

Thursday, August 11 7:30 a.m.–12:00 p.m.

Sponsored by Meta

KEY

- Elevators
- Tables
- Sold Booth
- Posters
- ePoster Tables

JSM 2022

CONVENTION CENTER HALL D



EXHIBIT HALL

AAAS	210	International Statistical Institute	202	RTI International	502
Abt Associates	408	JMP Statistical Discovery ..	219	Sandia National Labs	232
Addinsoft XLSTAT	301	K3-Innovations.....	508	SIAM	417
American Statistical Association.....	607, 609, 611	Lumbrita	620	Softlytics	318
ASA Store	612, 711	Mayo Clinic	419	Springer	709
AstraZeneca	333	Merck	211	StataCorp	501, 503, 505, 507
Bayesic Technologies	217	Meta	206	SSC.....	719
Berry Consultants	412	Minitab	307	The Lotus Group.....	311
Bureau of Labor Statistics	717	MIT	618	The Sensible Code Company	331
Bureau of Transportation Statistics	410	Mitre Corporation	601	US Census Bureau	517, 519
Cambridge University Press	402, 404	National Assessment of Educational Progress	622	University of Florida	509
Carnegie Mellon University Software Engineering Institute	118	National Center for Health Statistics, CDC	112	University of Kansas, Dept. of Biostatistics & Data Science	510
Circuit Breaker Labs	320	National Center for Science and Engineering Statistics	227	Unlearn.ai	209
Cytel	208	National Science Foundation	221, 223, 225	VTEX.....	303
Daiichi Sankyo	212	National Security Agency .	406	Westat	418
FDA, Center for Drug Evaluation and Research.....	120	nQuery/StatSol	506	YouTube.....	337
Hawkes Learning	603	Otsuka Pharmaceutical	628		
Innovativ Statistics	309	Penfield Search Partners ..	504		
Insilicom	420	The Pennsylvania State University	512		
Institute for Mathematical and Statistical Innovation .	605	Plat AI	626		
Institute of Mathematical Statistics	610	PNNL.....	305		
		Project Euclid	511		



FOOD CONCESSIONS

Looking for coffee, lunch, a snack? Why not head to **Uptown Dining District** (right outside Hall D) and grab something to eat before heading into the EXPO to check out the cutting-edge companies showcased on the exhibit floor.

JSM CAREER SERVICE

Would you like to explore career opportunities with top statistical employers? The JSM Career Service, located in Hall D of the Walter E. Washington Convention Center, will give you the opportunity to research job postings and contact employers. Access is for registered applicants and employers only, and interviews are by appointment.

Not already registered? Visit the main JSM registration area and ask to add the Career Service to your registration.

ASA Student Member	\$75
Student Nonmember	\$100
ASA Member	\$150
Nonmember	\$225

Executive Suite Employers

abbvie



Boehringer
Ingelheim

Carnegie Mellon University
Software Engineering Institute

CHASE

Lilly

HHS/FDA/CTP/OS/STATS

phastar

Pacific Northwest
NATIONAL LABORATORY

Proudly Operated by **Battelle** Since 1965

Sandia
National
Laboratories

STATA

FDA U.S. FOOD & DRUG
ADMINISTRATION

VERTEX

Career Service at JSM 2022

HALL E | WALTER E. WASHINGTON CONVENTION CENTER

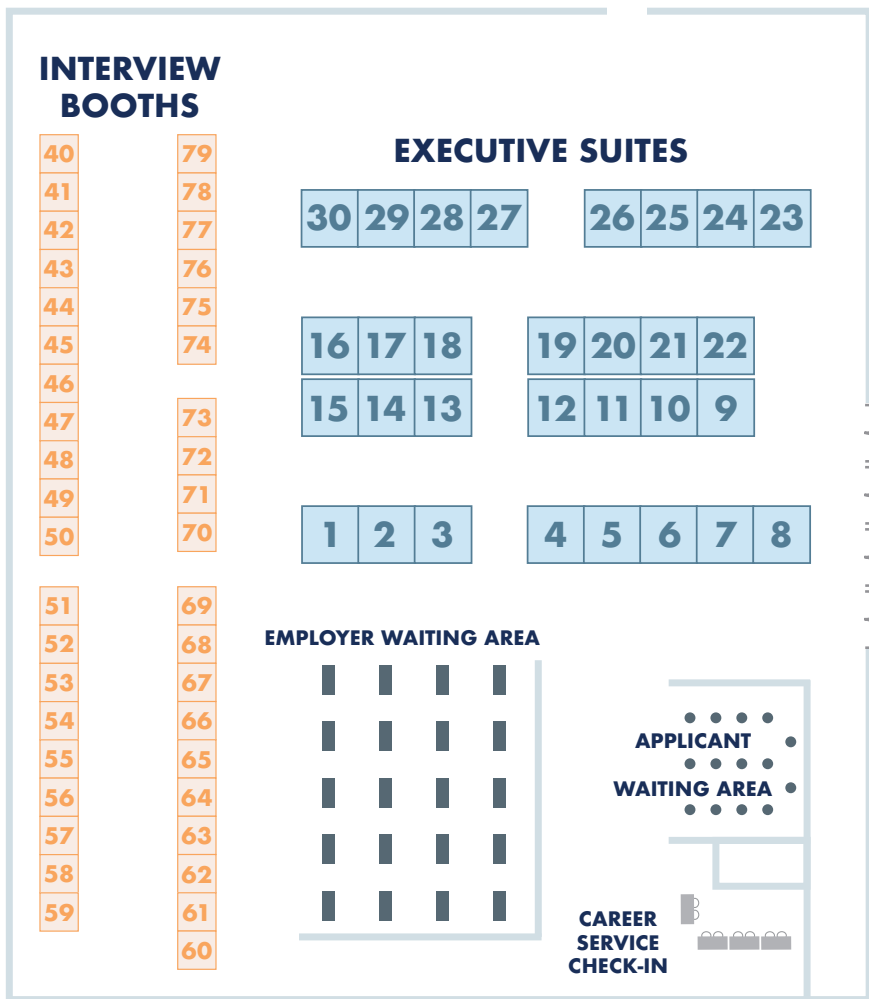

EXECUTIVE SUITE & BOOTH ASSIGNMENTS

AbbVie*	7
Analysis Group	51
Apple Inc.*	8
Astellas	63
AstraZeneca	53
Bank of America	54
BeiGene	72
Biogen*	15
Boehringer Ingelheim*	14, 75
Bristol Myers Squibb	78
Carnegie Mellon University Software	
Cincinnati Children's Hospital	56
Engineering Institute*	10
Edwards Life Sciences	47
Emmes	55
Engineering Institute*	10
Eli Lilly and Company*	1, 70
Exponent	65
FM Global	66
Horizon Therapeutics*	2
Illumina	50
Institute for Defense	
Analyses	73
JP Morgan Chase*	16, 74
Lubrizol	77
Mayo Clinic	52
Merck	71
Metropolitan State	
U of Denver	62
National Security	
Agency	60, 61
Novartis	69
PHASTAR*	5
PNNL*	4
RTI International	68
SANOFI	49
Sandia National Laboratories*	12
StataCorp*	3
Stevens Capital	
Management LP	64
US Census Bureau	48
US Food and Drug	
Administration*	6
US Food and Drug	
Administration, CDER*	9
US Food and Drug	
Administration, CTP*	13
United Network for	
Organ Sharing	79
Unlearn	76
Vertex Pharmaceuticals*	11
Walt Disney*	17
Westat	67

* = Executive Suite Employer

PROFESSIONAL DEVELOPMENT



The Professional Development program at JSM offers more than 30 short courses and workshops on topics such as big data, clinical trials, statistical computing, and soft skills. Titles, instructors, descriptions, and schedules are available on the JSM app and conference program at ww2.amstat.org/meetings/jsm/2022/onlineprogram.

All Professional Development offerings are at the Walter E. Washington Convention Center. Most require an additional fee.

To add a course or workshop, go to the main registration desk found in the East Salon of the convention center.

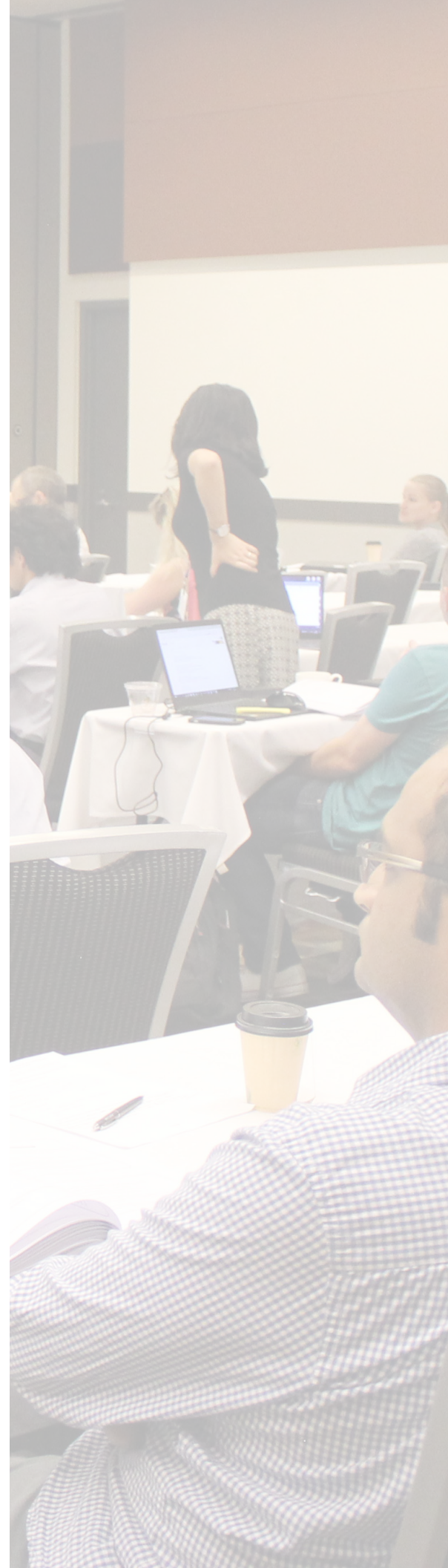

ROUNDTABLES

Looking for something to do for breakfast or lunch? Want a less formal presentation and a way to meet new people? A JSM roundtable discussion might be right for you.

Look through the options in the JSM conference program or app and check with JSM registration for availability.

There are also four Speaker with Lunch sessions to choose from:



Sunday, August 7, 12:30 p.m. – 1:50 p.m.

SPAIG Committee Speaker with Lunch *(Added Fee)*
A Framework for Scientific Integrity in Statistical Context

Christopher Marcum, *White House Office of Science and Technology Policy*



Monday, August 8, 12:30 p.m. – 1:50 p.m.

Section on Statistics in Sports Speaker with Lunch *(Added Fee)*
A Review of Causal Inference in Sports

Katherine Evans, *Monumental Basketball*



Tuesday, August 9, 12:30 p.m. – 1:50 p.m.

Economic Outlook Luncheon *(Added Fee)*
Supply Chains: What We Know and What We Wish We Knew

Susan Helper, *Case Western Reserve University*



Wednesday, August 10, 12:30 p.m. – 1:50 p.m.

Health Policy Statistics Section Speaker with Lunch *(Added Fee)*
The Need for, and Challenges of, Policy Evaluation During the COVID-19 Pandemic

Elizabeth Stuart, *Johns Hopkins University*



**CANCER HAS
NO BORDERS.
NEITHER
DO WE**

Our mission is patients first through science and affordability. To help transform the biotechnology industry, creating impactful medicines that will be affordable and accessible to far more cancer patients around the world through science and business innovation.

8,000+

employees
(as of January 2022)

30+

filed or potentially registration
enabling trials ongoing, **95+** studies
in **40+** geographies

~50

commercial or clinical
stage assets

30

offices on
5 continents

20+

filings accepted for **10** medicines in
over **50** geographies, including 2nd
drug in U.S. and first in E.U.

9

approved medicines,
including **1** in the US

BGNE-23-004 REV 2/22





Website:
BeiGene.com

Twitter:
[@BeiGeneGlobal](https://twitter.com/BeiGeneGlobal)

LinkedIn:
linkedin.com/company/beigene

JSM 2022

WALTER E. WASHINGTON CONVENTION CENTER LEVEL 1

KEY	
	Wi-Fi
	Restrooms
	Escalators
	Automatic External Defibrillators

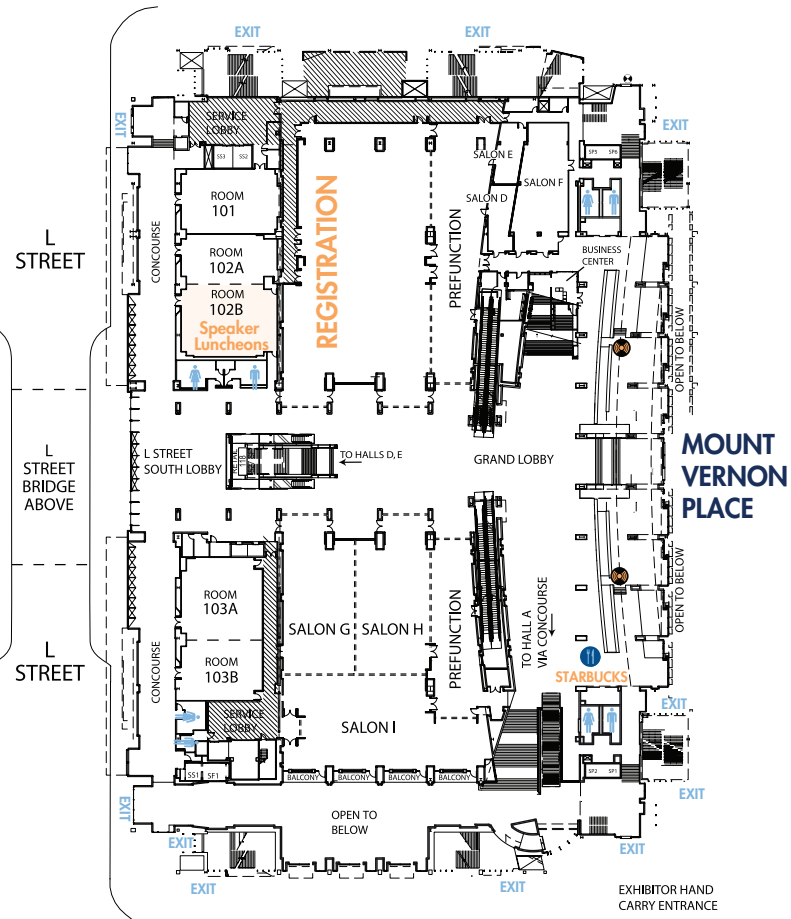



Community and committee tables span the corridors between rooms 140–160.

JSM2022

WALTER E. WASHINGTON CONVENTION CENTER LEVEL 2

KEY

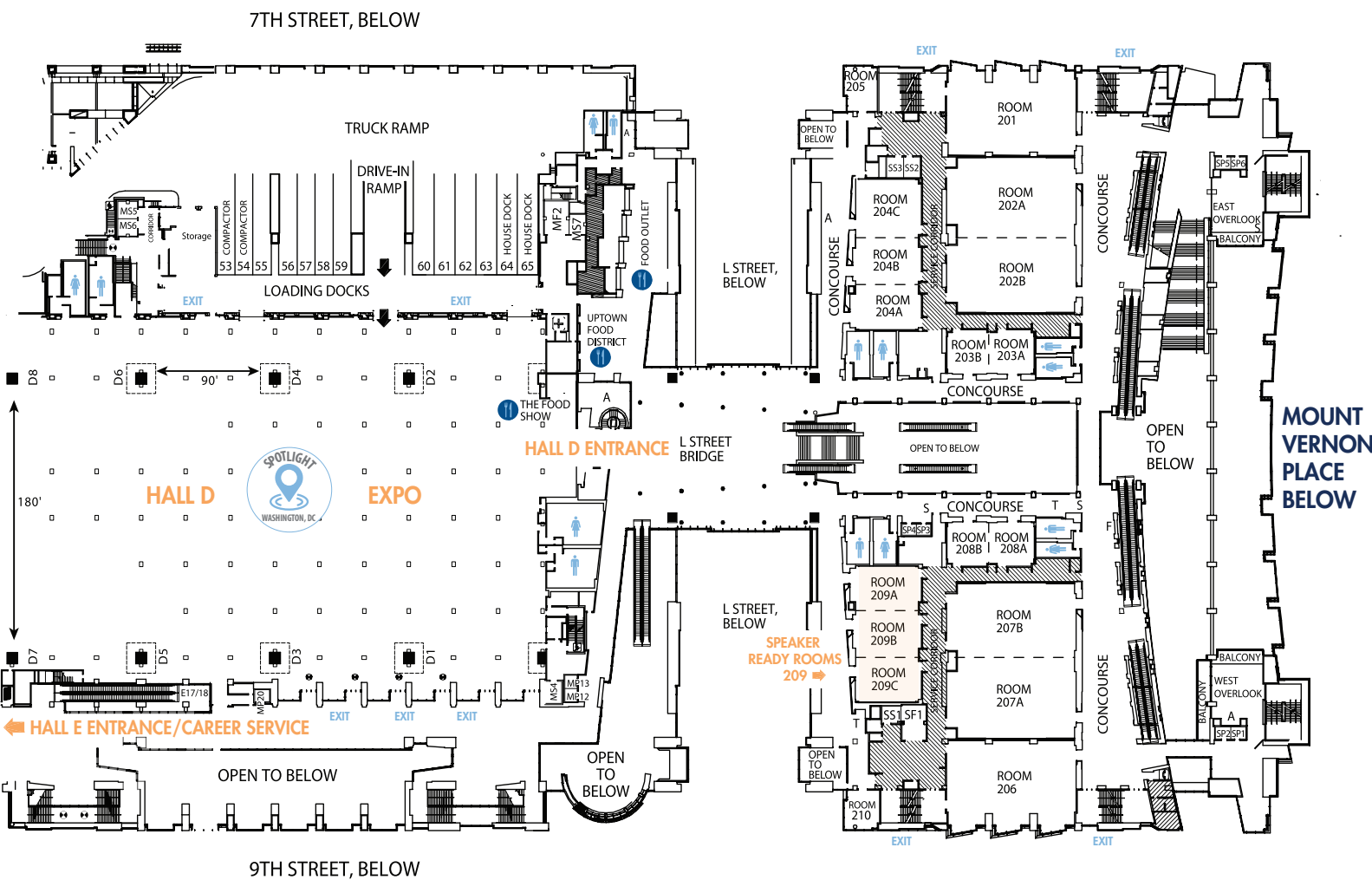

-  Restrooms
-  Escalators
-  Automatic External Defibrillators



JSM 2022

WALTER E. WASHINGTON CONVENTION CENTER LEVEL 3

KEY

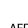
-  Restrooms
-  Escalators
-  Automatic External Defibrillators

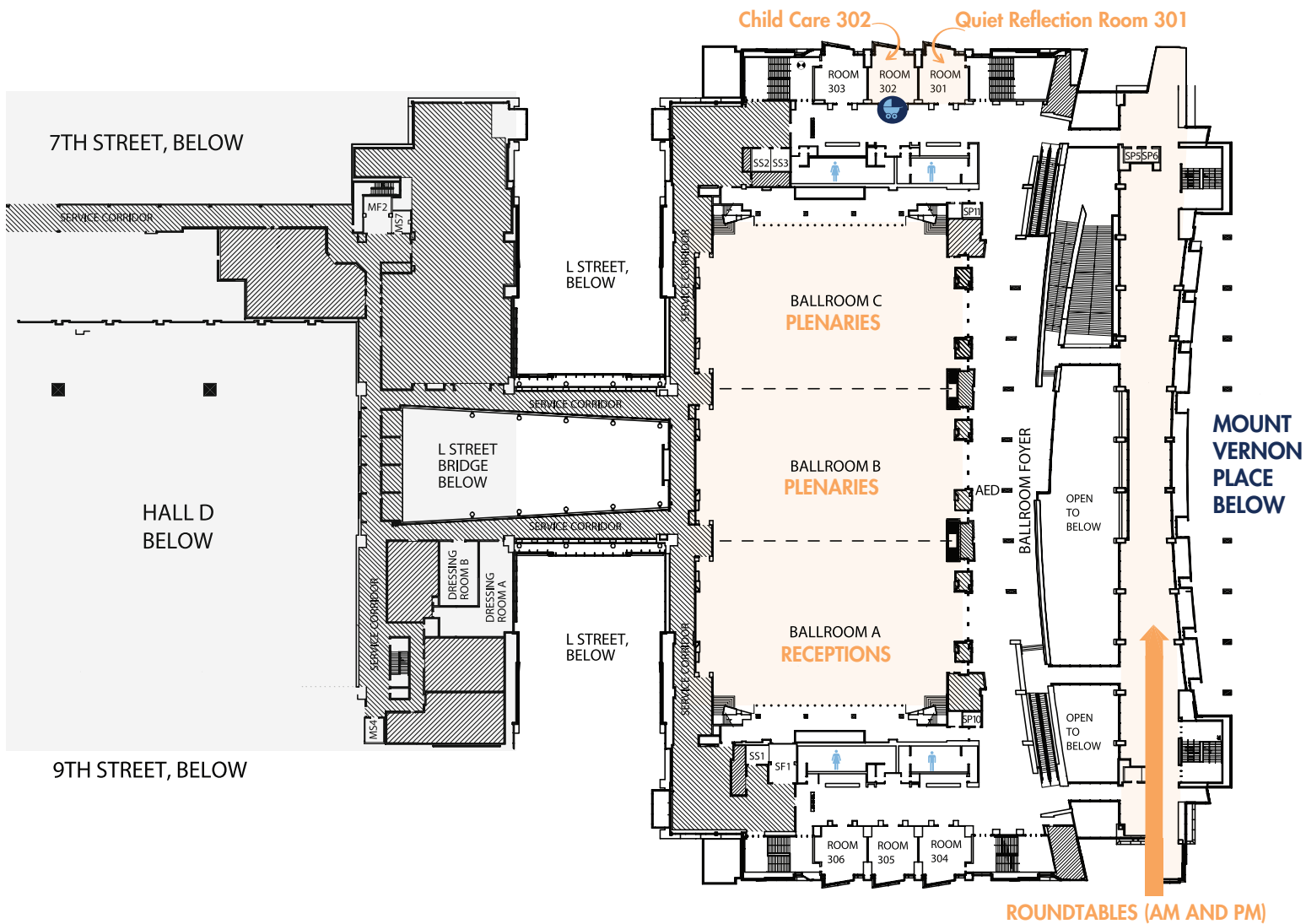

JSM2022

MARRIOTT MARQUIS WASHINGTON, DC

MEZZANINE | 2nd floor

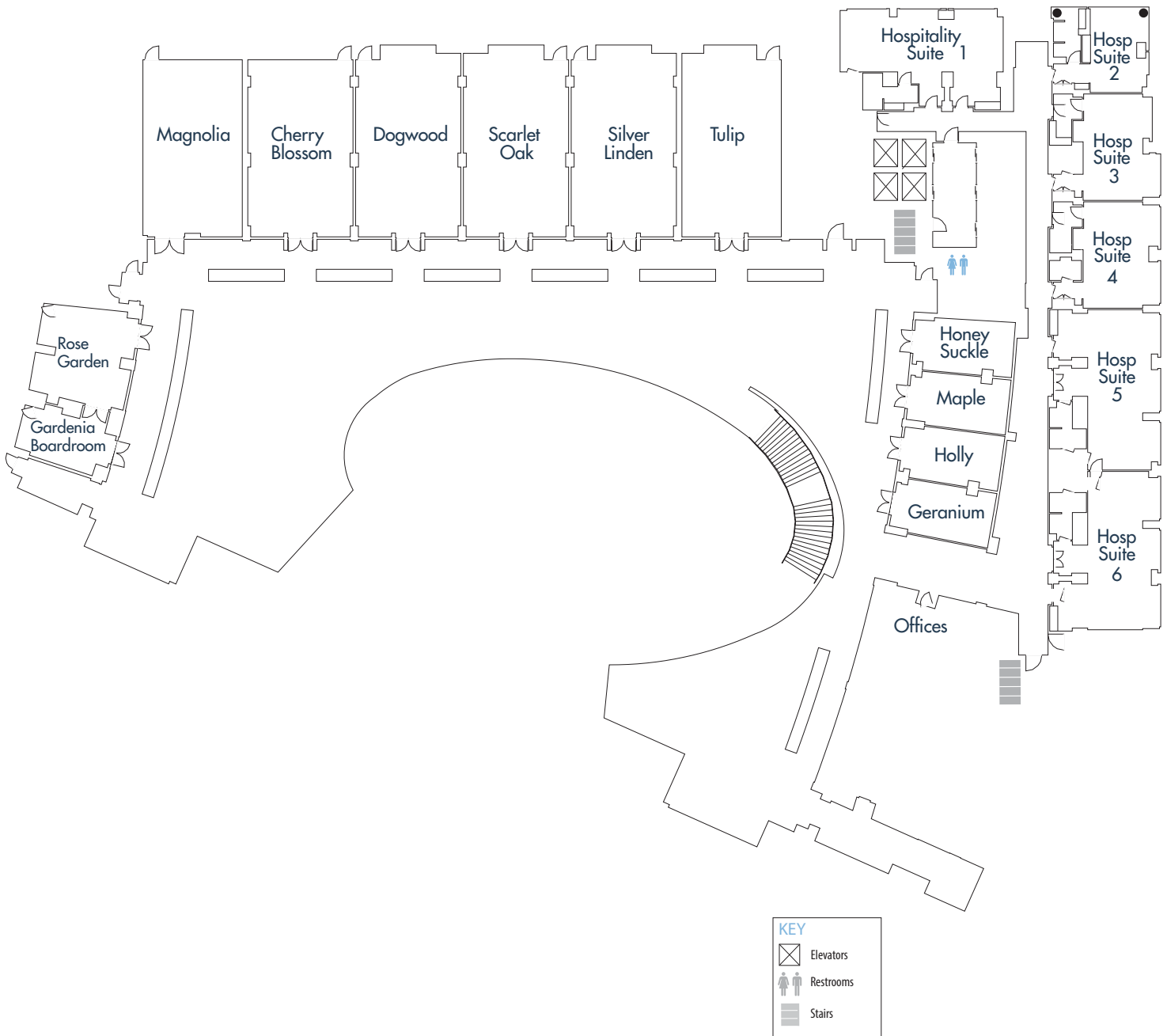

JSM2022

MARRIOTT MARQUIS WASHINGTON, DC

Third floor

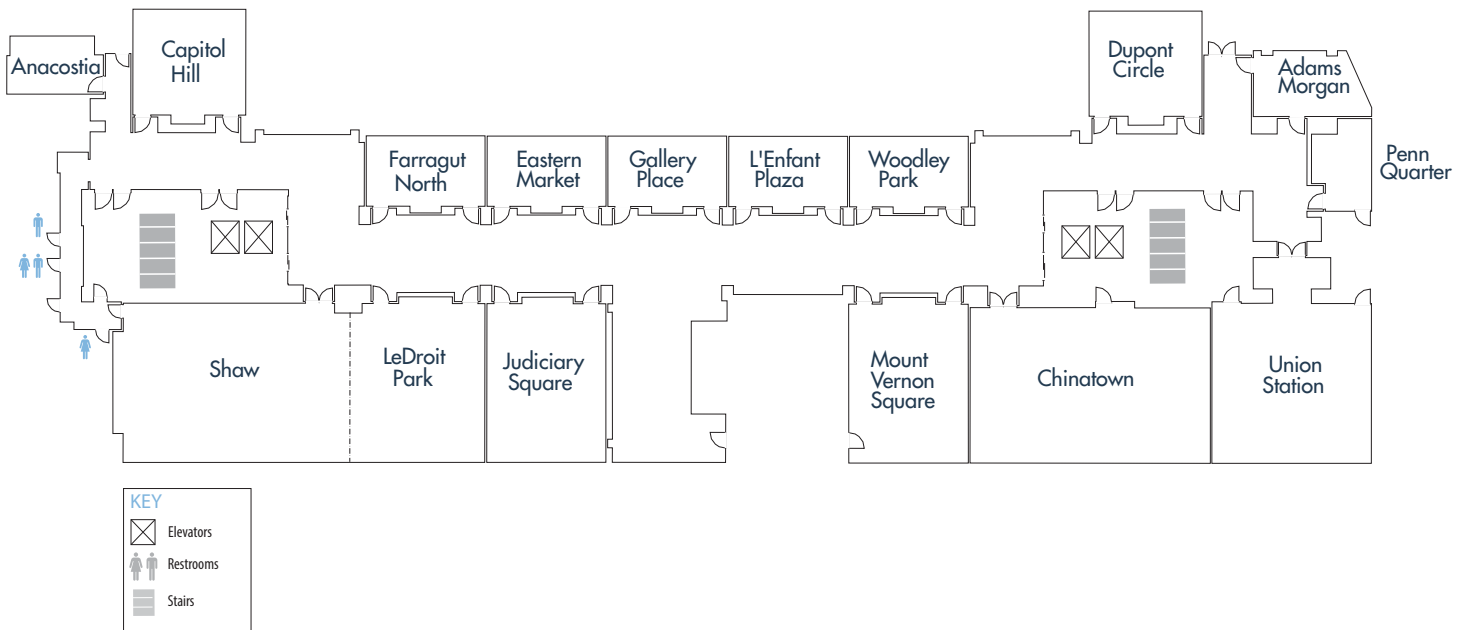

JSM2022

MARRIOTT MARQUIS WASHINGTON, DC

Fourth floor

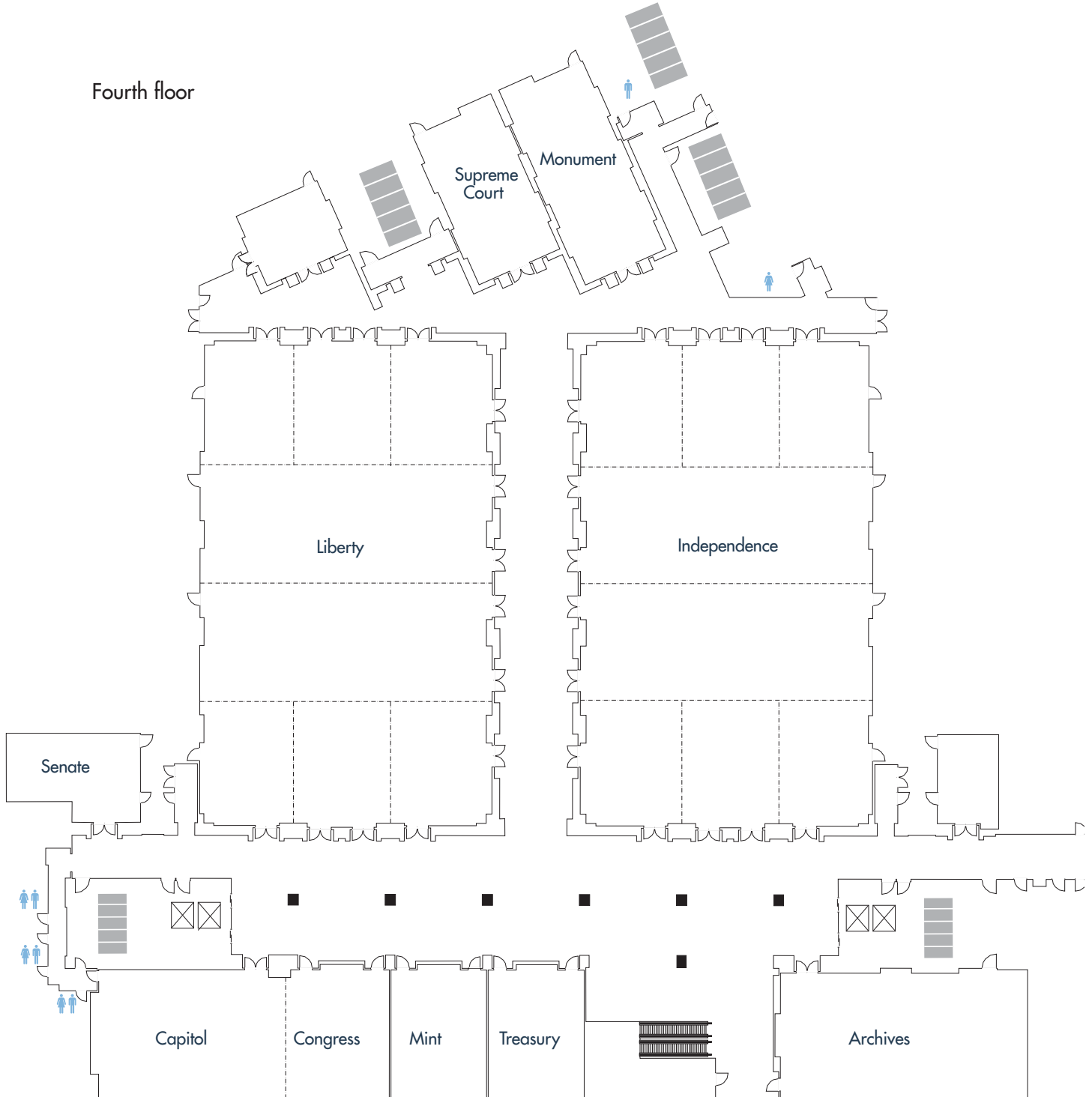

KEY	
	Elevators
	Restrooms
	Stairs

NOTE PAGES

What are your big goals for JSM 2022?

Write them down here and think about how the sessions and events you attend can help you achieve them.

NOTE PAGES

Tools and insights I don't want to forget:

Take good notes about the best ideas you hear at JSM. You'll be glad you did when you get home and are reflecting on how to put your JSM experience to work.

NOTE PAGES

Connect with these people:

Say hello to speakers and fellow attendees, then write down who you plan to follow up with and why so you can take action later!

NOTE PAGES

NOTE PAGES

NOTE PAGES

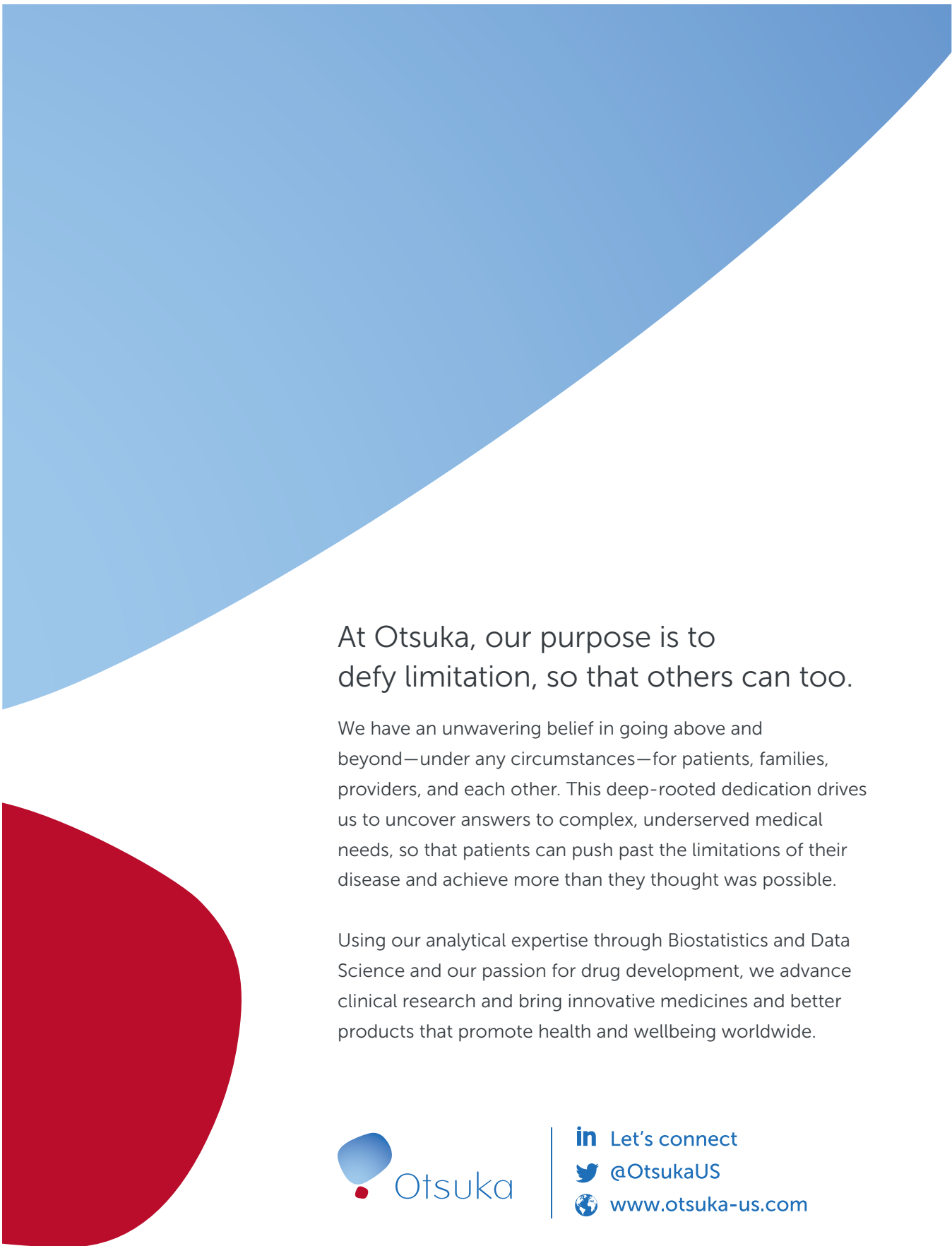

At Otsuka, our purpose is to
defy limitation, so that others can too.

We have an unwavering belief in going above and beyond—under any circumstances—for patients, families, providers, and each other. This deep-rooted dedication drives us to uncover answers to complex, underserved medical needs, so that patients can push past the limitations of their disease and achieve more than they thought was possible.

Using our analytical expertise through Biostatistics and Data Science and our passion for drug development, we advance clinical research and bring innovative medicines and better products that promote health and wellbeing worldwide.



 Let's connect

 @OtsukaUS

 www.otsuka-us.com



SAS[®] WAS CREATED BY THE CURIOUS, FOR THE CURIOUS.

Our comprehensive and scalable statistical analytics software is unmatched in the industry. From traditional statistical analysis of variance and predictive modeling to exact methods and statistical visualization techniques, SAS/STAT[®] software on SAS[®] Viya[®] is designed for both specialized and enterprisewide analytics.

Explore the latest training and documentation at support.sas.com/stat.

